

CMCP570(A) Solid State Temperature Transmitter/Monitor



Transmitter Features:

- Temperature Output
- "T" Type Accelerometer Input
- Output in °C or °F
- 4-20mA Output
- Two Buffered Outputs
- Class 1 Division 2, Groups B-D
- CE Approved

Monitor Features:

- OK, Alert and Danger Alarms
- 5A @250VAC Relay Outputs
- Latching or Non-Latching Alarms
- Trip Multiply (2x or 3x)
- Selectable Time Delay
- API 670 Compliant

The **CMCP570 Solid State Temperature Transmitter** and **CMCP570A Solid State Temperature Monitor** are compatible with industry standard dual output or "T" type Accelerometers that have an internal temperature sensor. The temperature signal is processed into a 4-20 mA output that is proportional to the overall range. The 4-20mA signal can then be sent to the Plant PLC/DCS or other control system. An OK Fault Detection Circuit is provided along with a Timed OK Danger Defeat Circuit to prevent false alarms. The CMCP570 can be optionally ordered as the CMCP570A Monitor and be equipped with the optional alarm module that provides OK, Alert and Danger Alarms, along with relays, adjustable time delays and adjustable set points for standalone machine protection.

Dimensions:

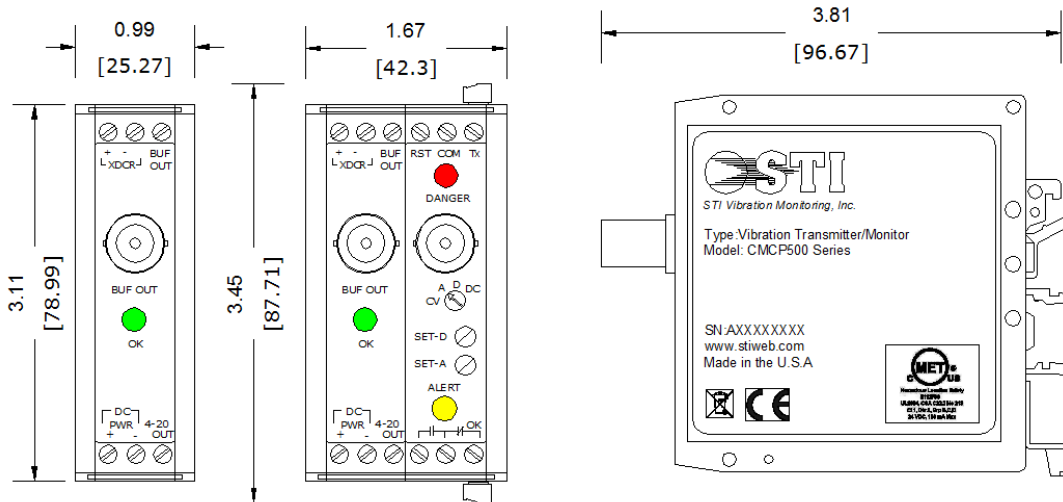

Transmitter

Monitor

Side View

Smart
Condition

Distribuidor Autorizado
contacto@smartcondition.mx
www.smartcondition.mx
Cel. (493) 106 9062
Cel. (493) 114 1974

CMCP570(A) Solid State Temperature Transmitter/Monitor

Specifications:

| Electrical Specifications: | CMCP570 |
|-------------------------------|---|
| Input: | Dual Output Accelerometers with Internal Temperature Sensor |
| Output: | 4-20 mA (600 Ohms max. resistive load) |
| Frequency Response @ -3db | DC |
| Power: | +24 VDC 50 mA max. Transmitter (100 mA max. Monitor) Reverse Polarity and Transient Protected |
| Accuracy: | 1% Full Scale |
| Range: | 10 mv/°K Type: 0 to 250°F (-17 to 121°C) 10 mv/°C Type: 35.6 to 248°F (2 to 120°C) |
| Signal Detection: | DC |
| Sensor Power: | 4.4 mA Constant Current Diode depending on Type |
| OK Circuit: | Green LED (On = OK), Not OK = Off and 4-20 mA < 2.0 mA |
| Timed OK Danger Defeat: | 30 Seconds on Power Up or Loss of OK (Alert and Danger) |
| Buffered Outputs: | Active Buffer, BNC and Terminal |
| Case: | Isolated |
| Terminals: | Screw Type, 24 AWG min., 12 AWG max. |
| Environmental Specifications: | |
| Operating Temperature: | -20°C to +80°C (-4°F to +176°F). |
| Storage Temperature: | -40°C to +95°C (-40°F to +203°F) |
| Relative Humidity: | 0 - 95% Non-Condensing |
| Mechanical Specifications: | |
| Mounting: | 32 mm (G style) or 35 mm (T style) DIN Rail. |
| Dimensions: | 0.99"W x 3.11"H x 3.81"D (25.27 x 78.99 x 96.67 mm) Transmitter 1.67"W x 3.11"H x 3.81"D (42.3 x 78.99 x 96.67 mm) Monitor |
| Weight: | 0.21 lb./0.40 lb. w/Alarm Module (0.095kg/0.18kg) |
| Certifications: | CE, RoHS, CSA & UL Approved Class I Division II B-D |

| Optional Alarm Module (Monitor): | CMCP570A |
|----------------------------------|--|
| Number of Alarms/Relays | 3 - OK, Alert and Danger |
| Alarm Indication: | OK = Green LED, Alert = Yellow LED, Danger = Red LED |
| Relay Specification: | 3 - Form C, SPDT, 5 Amp 30 VDC/250 VAC, Latching or Non-Latching |
| Alarm Time Delay: | Separately Selectable 0.1, 1.0, 3.0 6.0 10.0 Seconds |
| Trip Multiply Function: | Terminal for None, 2X or 3X Alarm Limit Trip Multiply |
| Reset Function: | Terminal for Remote Reset if Latching Alarms Selected |
| Bypass Function: | Hold Reset to Common |
| Display Output: | 0-5 VDC Switch Selectable Current Value, Alert and Danger Setpoint |

Ordering Information:

| | | |
|----------|----------|--|
| CMCP570 | -XX | Solid State Temperature Transmitter |
| CMCP570A | -XX | Solid State Temperature Monitor |
| | -01 | 10 mv/°K Type: 0 to 250°F (-17 to 121°C) |
| | -02 | 10 mv/°C Type: 35.6 to 248°F (2 to 120°C) (Standard) |
| | -Specify | Specify Input (Mod Charge Applies) |



**Smart
Condition**

1010 East Main St. League City, TX 77573 Phone: 281-334-0766 Fax: 281-334-4255
www.stiweb.com / www.stiwebstore.com

Distribuidor Autorizado

contacto@smartcondition.mx
www.smartcondition.mx
 Cel. (493) 106 9062
 Cel. (493) 114 1974